

PS322TE

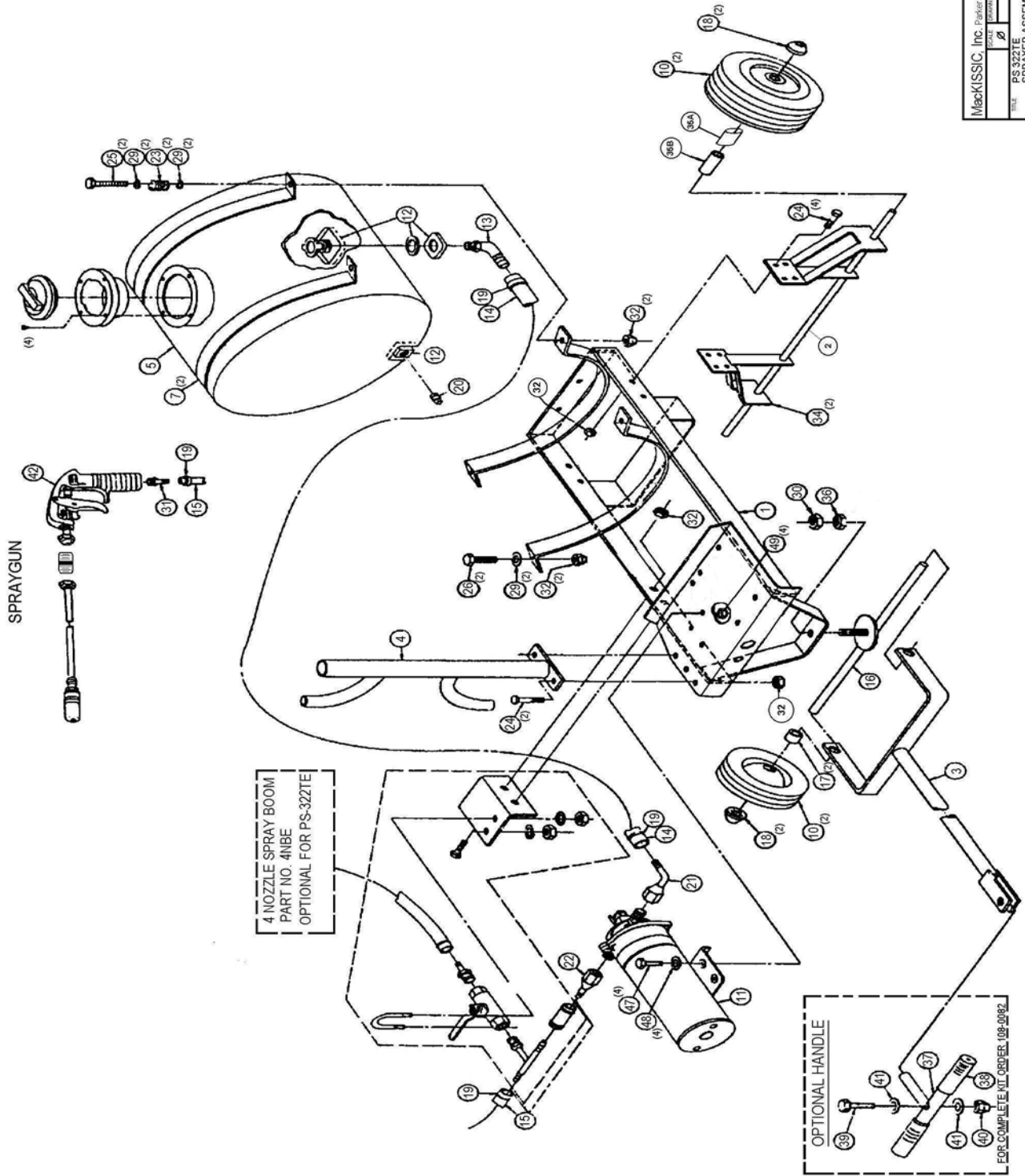

| | |
|--------------------------------|------------------------------|
| MackISSIC, Inc. Parker Ford PA | |
| SCALE | AS SHOWN |
| TITLE | PS 322TE SPRAYER ASSEMBLY |
| 3/2/88 | 108-0164 |

**PARTS LIST FOR SPRAYER
MODEL PS322TE**

| ITEM NO. | PART NO. | DESCRIPTION | QUANTITY |
|----------|------------|---------------------------------------|----------|
| 1 | 108-0066 | Main Frame Weldment | 1 |
| 2 | 108-0095 | Rear Axle | 1 |
| 3 | 908-0029 | Tow Hitch Weldment | 1 |
| 4 | 108-0025 | Hose Rack Weldment | 1 |
| 5 | 100-0221 | 22 Gal. Tank (Includes Lid & Screws) | 1 |
| 7 | 108-0054 | Tank Band | 2 |
| 10 | 703-0108 | Wheel (4.10/3.50-4 Pneumatic) | 4 |
| 11 | 108-0318 | Electric Pump | 1 |
| 12 | 100-0031 | Bulk Head Fitting | 2 |
| 13 | 100-0088 | Nylon Ell 1/2" x 3/8" | 1 |
| 14 | 108-0170 | Suction Hose - 3/8 | 1 |
| 15 | 108-0322 | Spray Hose - 3/8 | 1 |
| 16 | 908-0032 | Front Axle Weldment | 1 |
| 17 | 500-0012-P | Front Wheel Spacer | 2 |
| 18 | 090-0457 | Push Nut Cap | 4 |
| 19 | 100-0139 | Plastic Hose Clamp | 4 |
| 20 | 100-0141 | Plastic Plug 1/2" | 1 |
| 21 | 108-0313 | Swivel Ell Adapter | 1 |
| 22 | 108-0321 | Straight Swivel Adapter | 1 |
| 23 | 509-0009 | Spring | 2 |
| 24 | 090-0088 | 5/16"-18 x 1" HHCS | 6 |
| 25 | 090-0079 | Tap bolt 5/16"-18 x 2-1/2" | 2 |
| 26 | 090-0078 | Tap bolt 5/16"-18 x 2" | 2 |
| 29 | 090-0233 | Flat Washer 5/16" | 6 |
| 30 | 090-0442 | 5/8"-11 Half Hex Nut | 1 |
| 31 | 100-0143 | Male Hose Insert 3/8" | 1 |
| 32 | 090-0460 | 5/16"-18 Nylock Nut | 12 |
| 34 | 908-0060 | Axle Bracket | 2 |
| 35A | 500-0071 | Axle Spacer, 7/8" Lg. | 2 |
| 35B | 500-0072 | Axle Spacer, 1-1/2" Lg. | 2 |
| 36 | 090-0210 | Hex Nut 5/8"-11 | 1 |
| 37 | 908-0030 | Pull Handle (Optional) | 1 |
| 38 | 500-0041 | Handle Grip (Optional) | 2 |
| 39 | 090-0112 | 3/8"-16 x 1-1/2" HHCS (Optional) | 1 |
| 40 | 090-0461 | 3/8" Nylock Nut (Optional) | 1 |
| 41 | 090-0234 | Flat Washer 3/8" (Optional) | 2 |
| - | 100-0159 | Spray Gun Kit Complete | - |
| 42 | 108-0347 | Spray Gun with extension and tip | 1 |
| 47 | 090-0400 | #10-32 x 1-1/4" Rd. Hd. Machine Screw | 4 |
| 48 | 090-0401 | Flat Washer #10-32 | 4 |
| 49 | 706-1539 | Kep Nut #10-32 | 4 |
| --- | 108-0315 | Wire Assembly - Switch to Battery | 1 |
| --- | 108-0314 | Wire Assembly - Switch to Pump | 1 |
| --- | 108-0328 | On/Off - Rocker Switch | 1 |
| --- | 108-0414 | Battery Hold Down | 1 |